

The most robust cleaver

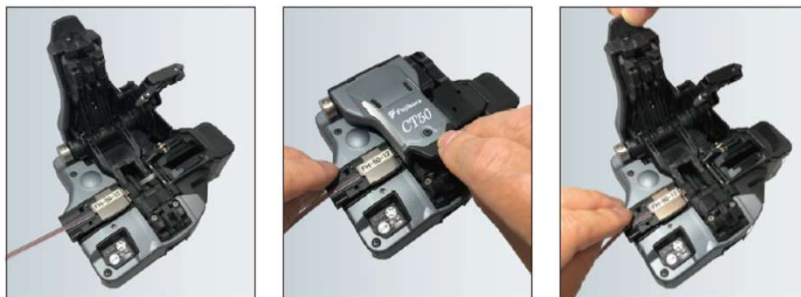

Fiber Cleaver

Fujikura CT50



- Applicable for up to 12-fiber cleaving
- Automatic cleaving blade rotation via wireless communication
- User replaceable fiber clamps and cleaving blade
- Blade life up to 60,000 cleaves
- Wide lever opening angle allows easy fiber placement
- Single-action operation including fiber scrap collection



Fujikura CT50

SPECIFICATIONS

Description		CT50
Applicable optical fiber		Silica optical fiber
Fiber count		Up to 12
Cladding diameter		125 μm
Coating diameter		160 to 900μm 2 to 3mm cord and drop cable
Cleaving length	AD-50	5mm to 20mm (coating diameter = 250μm) 10mm to 20mm (coating diameter > 250μm)
	Fiber holder	10mm (from the edge of FH:13mm)
Cleaving angle		Typical 0.5 degrees
Blade life		60,000 fibers (1,250 fibers x 3 heights x 16 positions)
Wireless connectivity		Bluetooth 4.1 LE*1
Power supply		AAA (LR03) dry battery: 2pc
Dimensions		120(W)x 95(D) x 58(H)mm
Weight		320g
Operation condition		0 to 95% RH and 0 to 40°C (non-dew)
Storage condition		0 to 95% RH and -40 to 80°C (non-dew)
Resistance features*2		Shock: 76cm (30inch) all directions drop
		Dust resistance: Exposure to dust (0.1 to 500μm dia. Alumina Silicate)
		Rain resistance: H=10mm/hr for 10min

*1 The Bluetooth wireless connection of this product is not guaranteed to work with all smartphones or other devices.

*2 Carried out in Fujikura labs in Japan. The shock resistance test does not guarantee the product will not be damaged under these conditions.

• Bluetooth® and Bluetooth logo is a registered trademark of Bluetooth SIG, Inc.



STANDARD PACKAGE

Description	Model No.	Qty.
Fiber plate	AD-50	1pc
Spacer	SPA-CT08-10	1pc
Carrying case	CC-37	1pc
Hexagonal wrench	HEX-01	1pc
Instruction manual	M-CT50-E	1pc

OPTIONAL ITEMS

Description	Model No.
Blade	CB-08
Arm set	ARM-CT08-01
Dust box	FDB-05
Blade rotary wheel	BRW-CT08-01
Side cover	SC-CT50-01

STANDARD PACKAGE



OPTIONAL ITEMS



FIBER HOLDERS

Description	Model No.
Applicable fiber holder	FH-50-xxx
	FH-60-xxx
	FH-100-xxx



Please visit **NEW** web site!

<https://www.fusionsplicer.fujikura.com>



Facebook

<https://www.facebook.com/FujikuraFusionSplicers>



twitter

<https://twitter.com/fujikurasplicer>

Specifications and descriptions are subject to change without prior notice. ©2018 Fujikura Ltd.

Fujikura Ltd.

1-5-1, Kiba, Koto-ku, Tokyo 135-8512, Japan
Phone:+81-3-5606-1164 Fax:+81-3-5606-1534 <http://www.fujikura.com>

PROFIBER
Profissionais de fibra

profiber@profiber.com.br | www.profiber.com.br

Profiber Telecomunicação e Eletricidade Ltda.

São Paulo - SP | Fone: 11 2239-4203

Fujikura
Authorized Dealer